

## FERRULE FOR HOSE 4SP - R9R - 4SH skive

Code: **8006..**  
Type: **BPSP - BPSH**

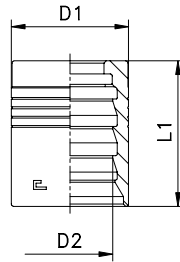

CODE	I.D. hose		Dimensions [mm]			Skiving lenght	Applicaztions
	INCH	DN	D1	D2	L1		
800602	1/4	6	22	15,4	30	23	4SP
800604	3/8	10	25	18,2	31	23,5	4SP
800605	1/2	12	29	21,6	35	26,5	4SP
800606	5/8	16	33	25	38	28,5	4SP
800607	3/4	19	38	29,2	43	32	4SP - 4SH
800608	1	25	45	36,2	58	44,5	4SP - 4SH
800609	1 1/4	31	52	43	64	49	4SH
800610	1 1/2	38	60	50	72	56	4SH
800611	2	51	75	64,3	81	63,5	4SH

**Notes:** If you wish to order a fitting in stainless steel, please change the first two digit from **80....** to **81....** .

## FERRULE FOR HOSE R7 - R7TM no skive

Code: **8008..**  
Type: **BP78**

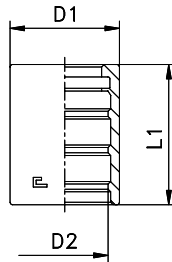

CODE	I.D. hose		Dimensions [mm]			Skiving lenght
	INCH	DN	D1	D2	L1	
800801	3/16	5	14	10,6	24	-
800802	1/4	6	17	13,4	25,5	-
800803	5/16	8	19	15,2	26,5	-
800804	3/8	10	21	16,7	27	-
800805	1/2	12	25,5	20,8	29	-
800806	5/8	16	28,5	24	32	-
800807	3/4	19	32	27,5	36	-
800808	1	25	40	34,5	44,5	-

**Notes:** If you wish to order a fitting in stainless steel, please change the first two digit from **80....** to **81....** .